

AERODROME CHART ICAD

RWY	QFU	THR	bearing / strength	TWR
11*	109°	N 38°04'30.36" E 015°38'22.69"	RWY 15/33 - From THR 15 to THR 33 = PCN 72/F/A/W/T	118.250
29	289°	N 38°04'09.21" E 015°39'27.06"	RWY 29 - From THR 29 TO RWY END 29 = PCN 83/F/A/W/T	
15	149°	N 38°04'45.98" E 015°38'46.33"		
33	329°	N 38°03'57.21" E 015°39'18.03"		

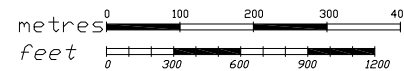

AD ELEV 95	REGGIO CALABRIA	
APRON ELEV 57	L I C R	38°04'19" N 015°39'13" E

Bearings are magnetic
Distances in metres
Elevation in ft AMSL
Coordinates WGS84

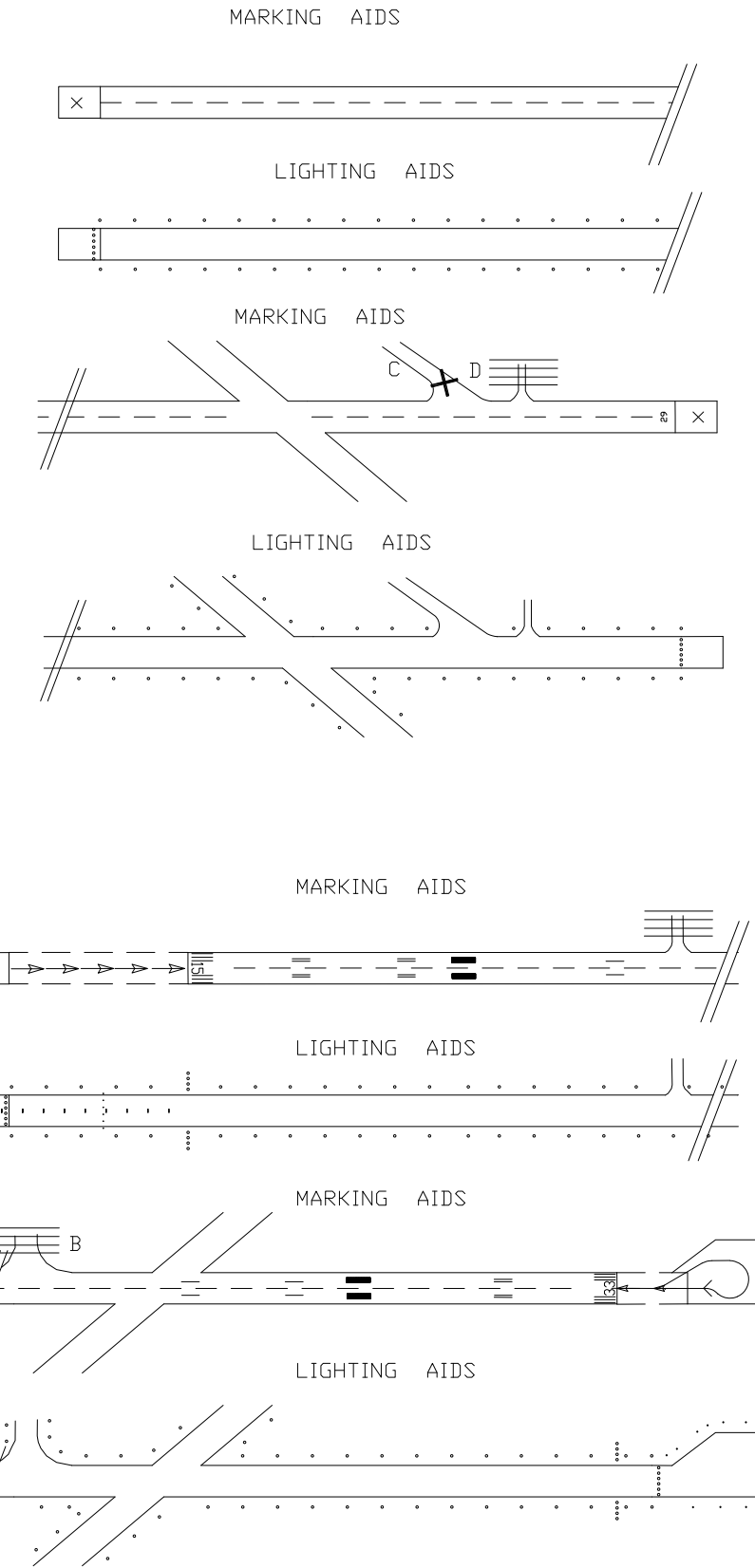
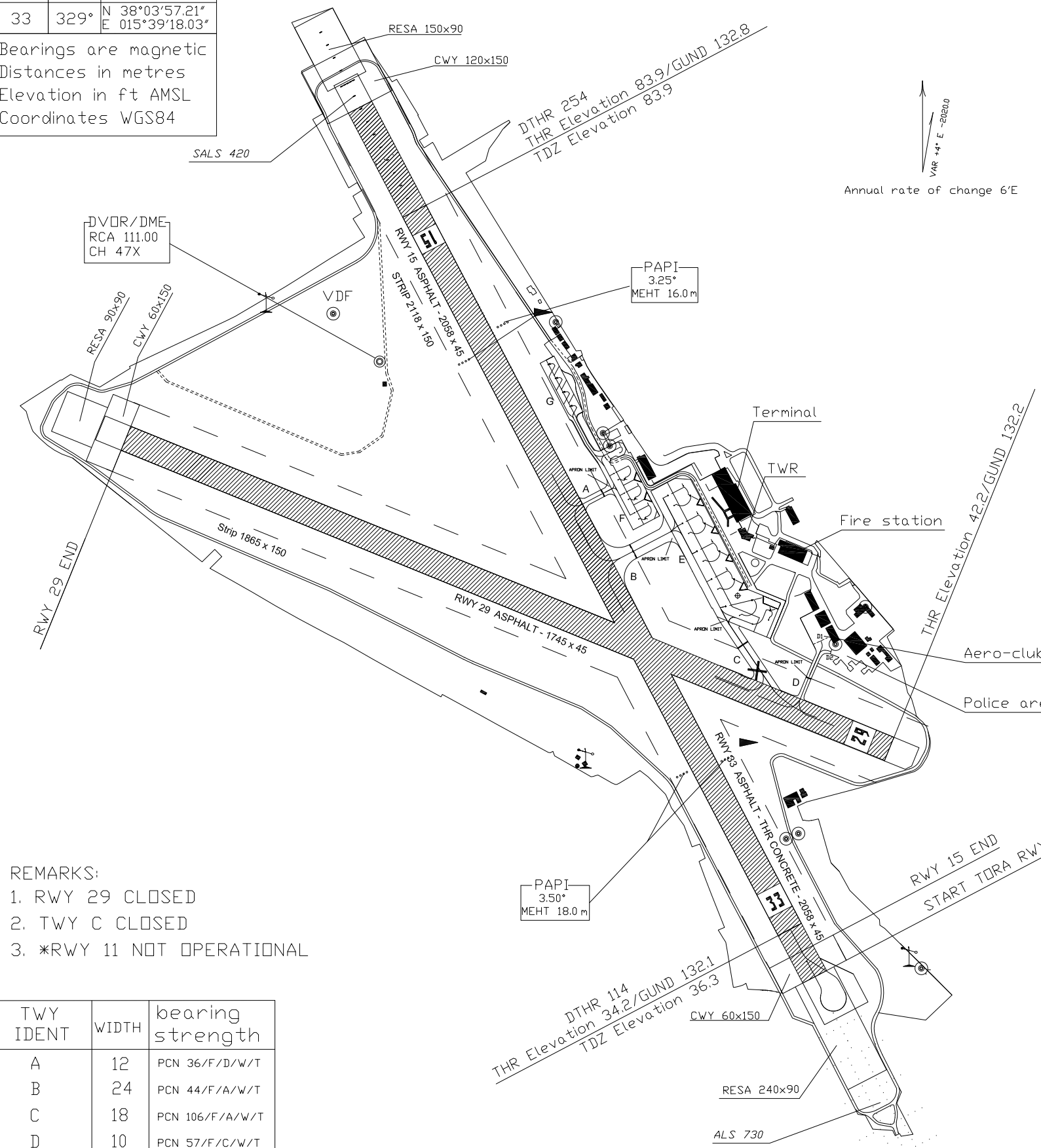

CHANGE: Magnetic variation/Annual change and QFU updated

- REMARKS:
1. RWY 29 CLOSED
2. TWY C CLOSED
3. *RWY 11 NOT OPERATIONAL

TWY IDENT	WIDTH	bearing strength
A	12	PCN 36/F/D/W/T
B	24	PCN 44/F/A/W/T
C	18	PCN 106/F/A/W/T
D	10	PCN 57/F/C/W/T

Data provided by S.A.CAL. S.p.A.

THIS PAGE
INTENTIONALLY
LEFT BLANK

HOT SPOT MAP (NOT FOR NAVIGATION)

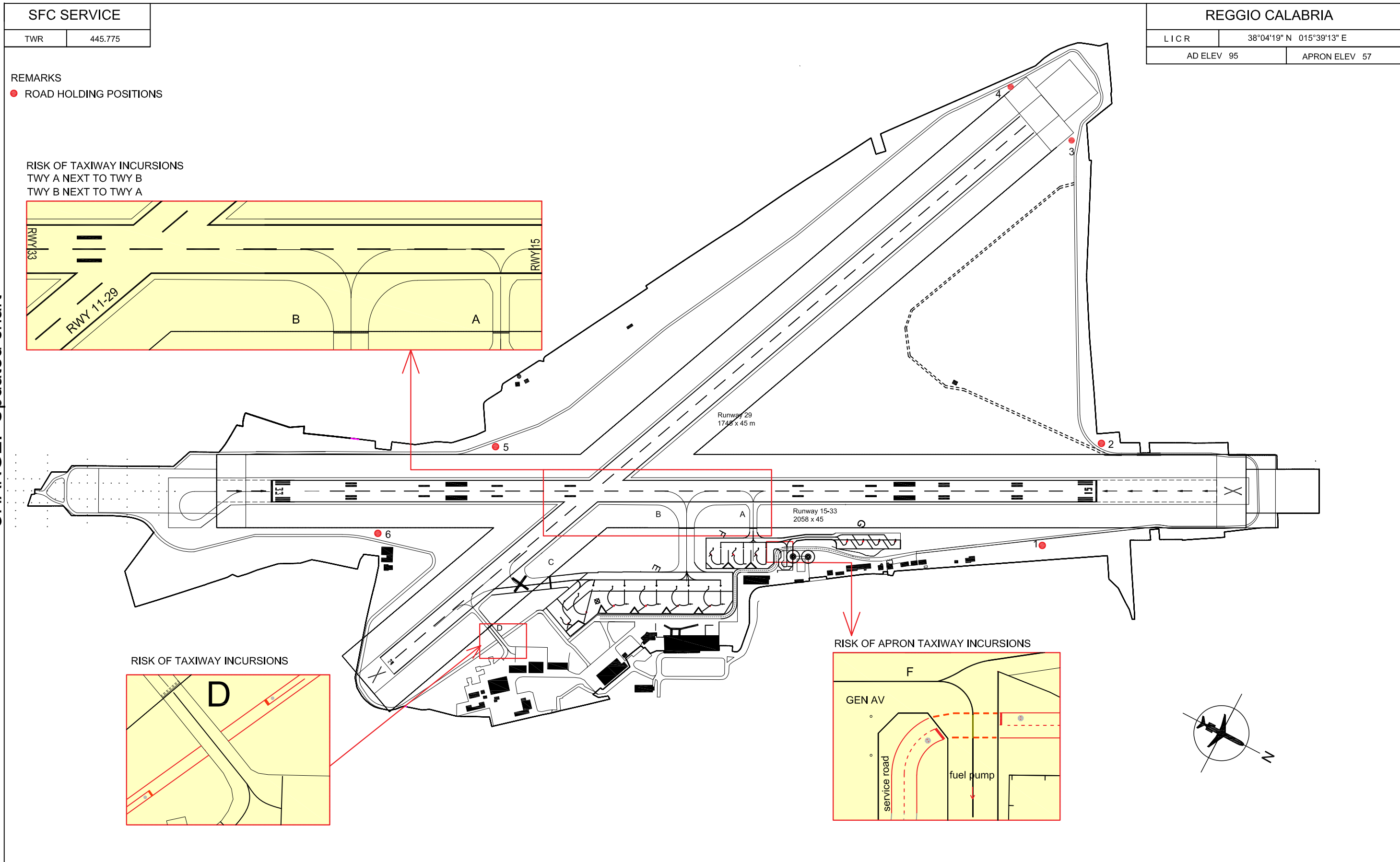

Data provided by S.A.CAL. S.p.A.

THIS PAGE
INTENTIONALLY
LEFT BLANK

AIRCRAFT PARKING DOCKING CHART

Bearings are magnetic Distances in metres Elevation in ft AMSL Coordinates WGS 84	TWR 118.250	AD ELEV 95	REGGIO CALABRIA		
		APRON ELEV 57	L I C R	38°04'19" N	015°39'13" E

APRON 1 (Main Apron)		APRON 2 (GEN AV)		APRON 3 (GEN AV)	
lighting	bearing strength	lighting	bearing strength	lighting	bearing strength
Edge: Blue	PCN 55/R/D/W/T	Edge: Blue	PCN 24/F/C/W/T	Nil	PCN 10I/F/A/W/T

POINTS ON PARKING AREA

STANDS	N	E	STANDS	N	E
101	38°04'26.53"	15°39'09.84"	201	38°04'27.72"	15°39'04.20"
102	38°04'24.68"	15°39'11.06"	202	38°04'26.44"	15°39'05.05"
103	38°04'22.84"	15°39'12.29"	203	38°04'25.14"	15°39'05.91"
104	38°04'20.99"	15°39'13.50"	301	38°04'32.58"	15°38'59.70"
105	38°04'19.58"	15°39'15.02"	302	38°04'33.54"	15°38'59.09"
106	38°04'18.89"	15°39'16.55"	303	38°04'34.45"	15°38'58.44"
			304	38°04'35.42"	15°38'57.89"

CHANGE: Magnetic variation/Annual change

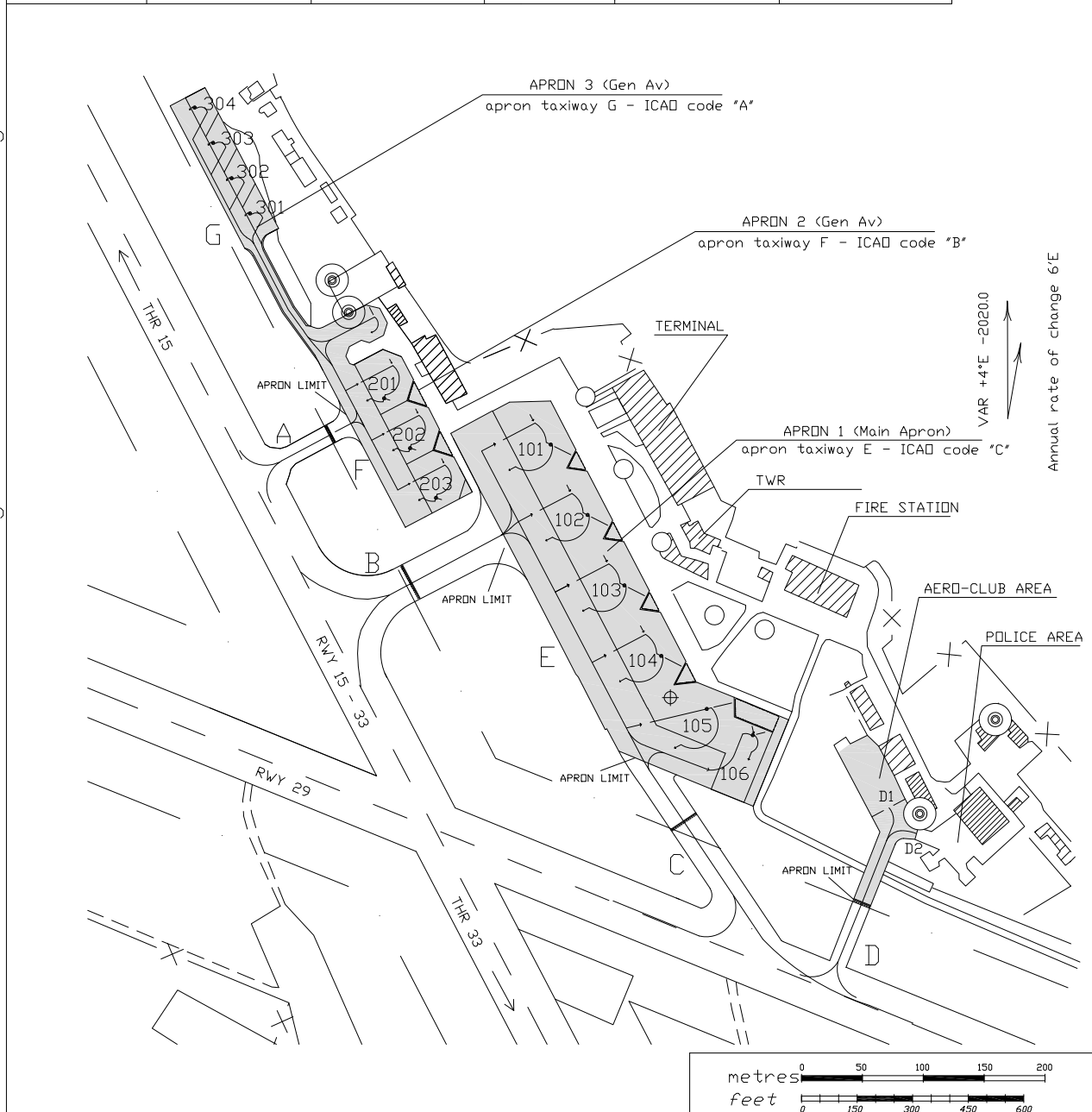

Data provided by S.A.CAL. S.p.A.

**THIS PAGE
INTENTIONALLY
LEFT BLANK**